



# NESTBLK

THE MOST FLEXIBLE FURNITURE SYSTEM FOR OPERATIONAL REAL ESTATE





- **DESIGNED FOR LIVING** 2
- **WHY NESTBLOK** 3
- **THE BED SYSTEM** 4
- **THE WALL SYSTEM** 5
- **PROVEN AT SCALE** 6
- **DESIGNED FOR LONGEVITY** 7
- **WHERE NESTBLOK FITS BEST** 8
- **WE'LL MAKE IT YOUR OWN** 9
- **TESTED & VALIDATED** 10
- **DESIGNER & SUPPLIER** 11
- **BOOK A CALL** 12





# DESIGNED FOR LIVING

Nestblok is a **modular furniture system** designed for compact residential environments such as PBSA, BTR, and co-living. It sits between joinery and loose furniture: robust enough for operational use, flexible enough to adapt over time.

The system is designed in response to residents' feedback, to maximise storage and personalisation opportunities.

# WHY NESTBLOK

Delivering truly innovative bedroom furniture within a standard development programme is typically time-consuming and consultant-heavy, often pushing projects back toward conventional solutions.

Developed through extensive prototyping and direct student research, **Nestblok** enables innovation by front-loading risk and technical refinement.

**Nestblok** is a made-to-order modular system, adaptable in layout, configuration and finishes. Interchangeable components and integrated moving elements provide flexibility — including during residents' use — without introducing mechanical complexity.



[ENQUIRE NOW](#)



# THE BED SYSTEM

Nestblok is composed of repeatable modules that can be **COMBINED, REMOVED, OR REPLACED INDEPENDENTLY.**

Customisable under bed storage with interchangeable multiple components

Main bed frame is fixed, residents can change accessories independently

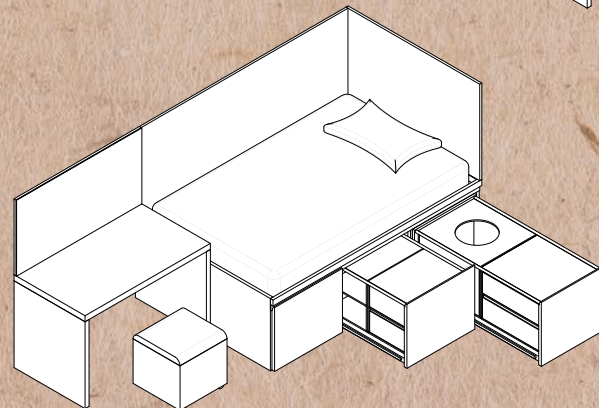
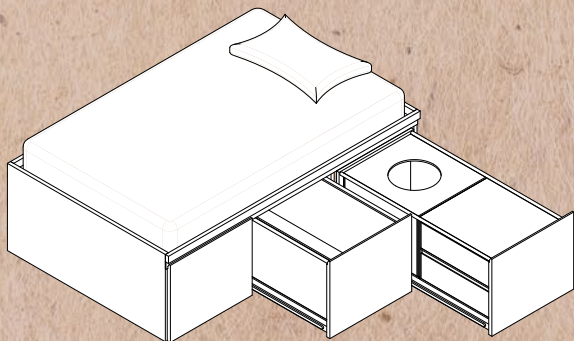
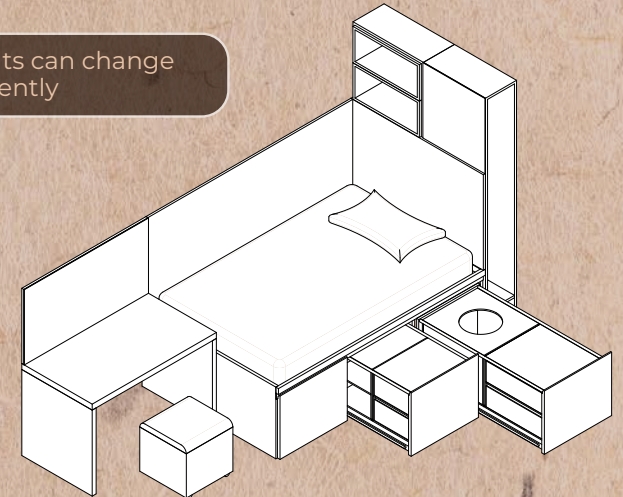
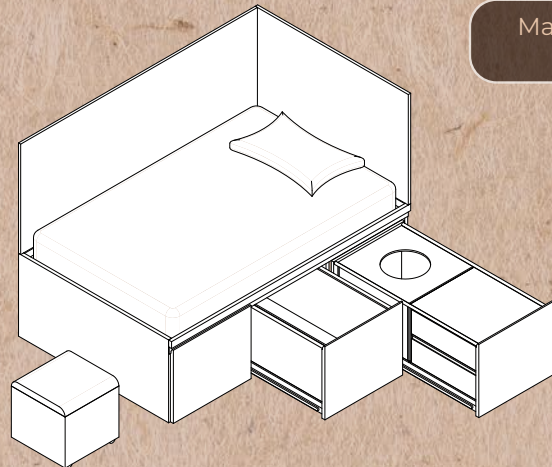

# THE WALL SYSTEM

Modules can be **reconfigured** to suit:



Individual or twin layouts

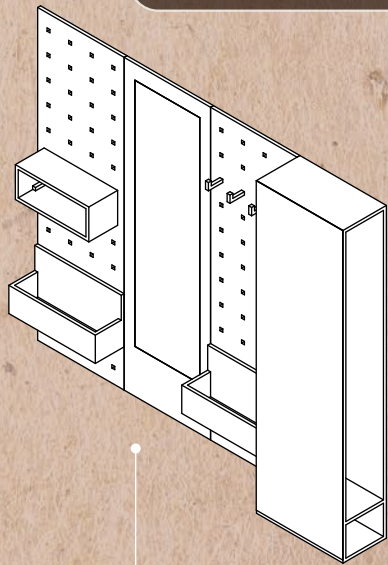

Different room size

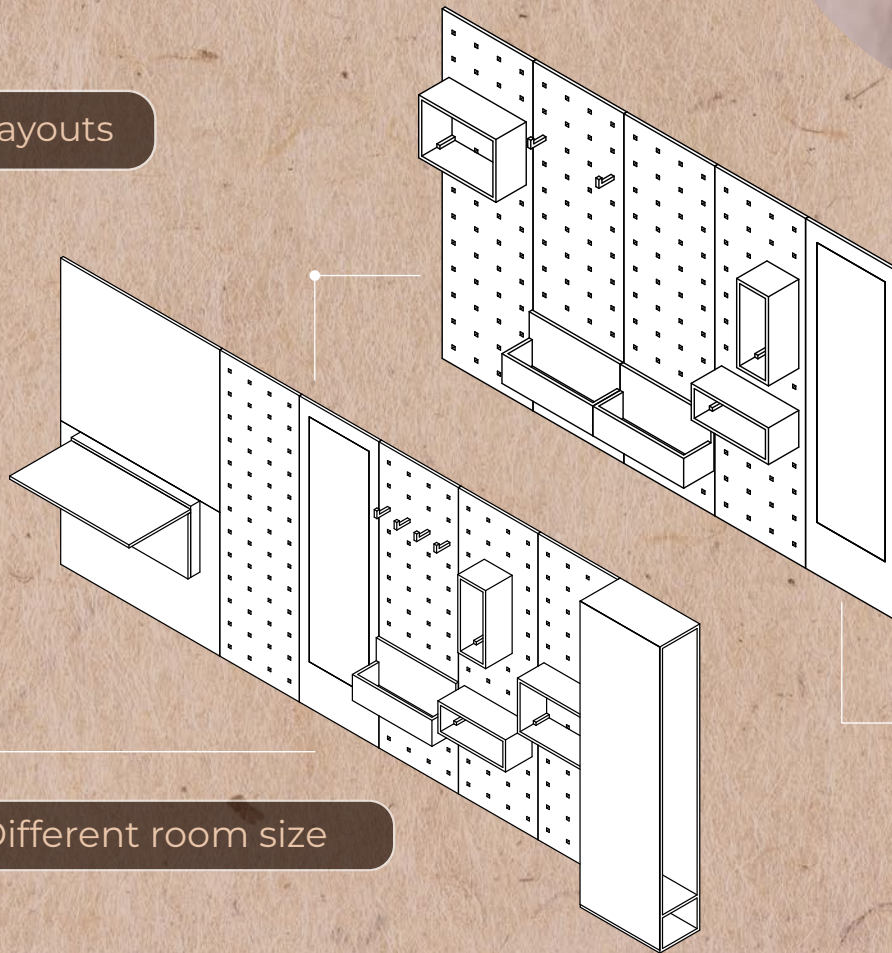

Changing needs

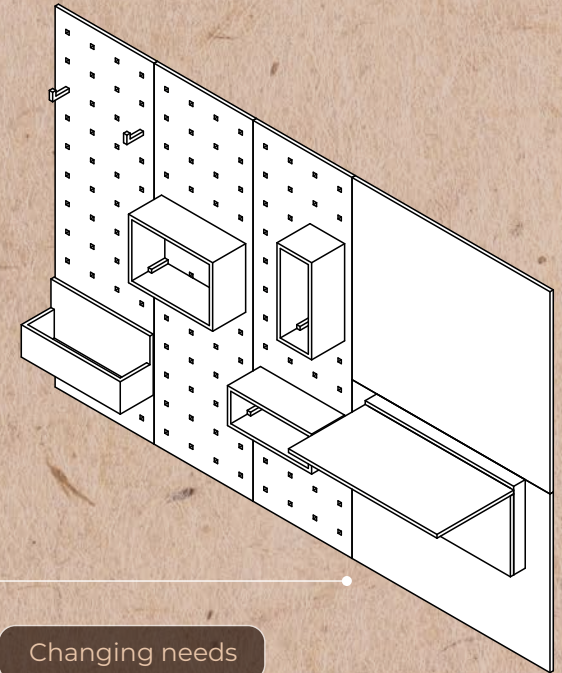

# PROVEN AT SCALE



**Nestblok** modules are built on  
real-world experience.

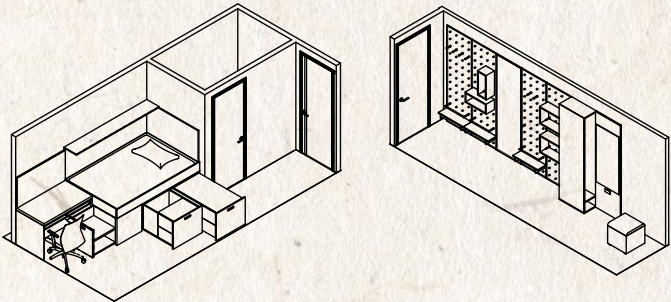
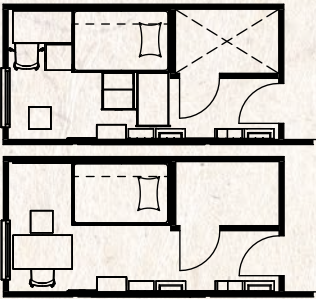

Tested across **60+ operational residential projects** and **over 20,000 beds delivered throughout Europe**, the system distills insights from live buildings, post-handover feedback, refurbishment constraints, and long-term operational use.

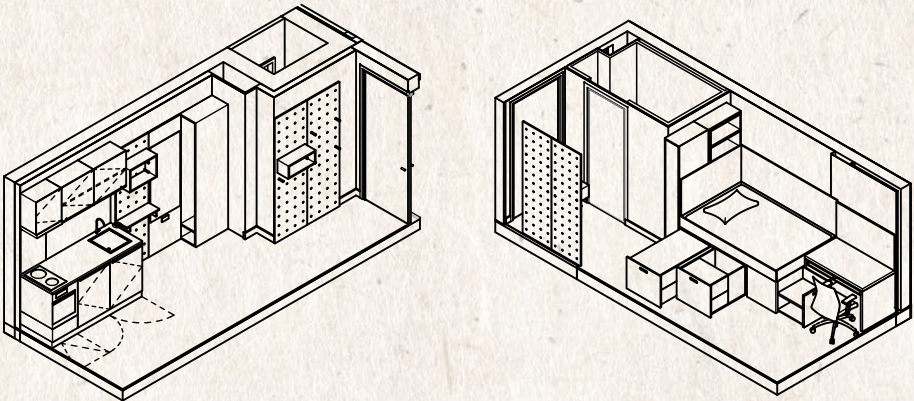
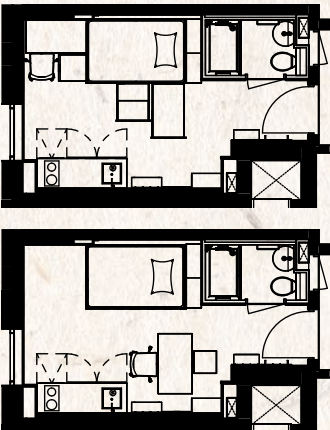
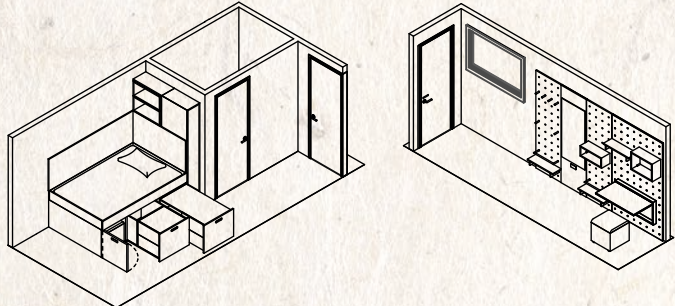
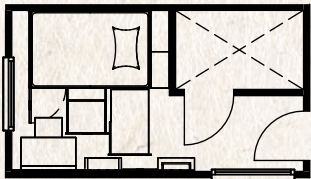

**Designed for how buildings  
are actually lived in and run.**



# DESIGNED FOR LONGEVITY

**SUSTAINABLE AND CIRCULAR**  
BUILT TO ADAPT, DESIGNED TO PERFORM

Individual components can be replaced or reconfigured independently, without dismantling the entire unit, significantly reducing material waste and offering simple customisation opportunities during lifecycle.

Manufactured using durable contract-grade materials and FSC-certified wood, Nestblok offers faster installation compared to traditional fitted furniture.



# WHERE NESTBLOK FITS BEST

The system works across both new-build and refurbishment projects. It integrates naturally with typical PBSA, and co-living layouts.

Nestblok works best for clients managing multiple buildings or large portfolios, where consistency, adaptability, and long-term performance matter.

# WE'LL MAKE IT YOUR OWN

Nestblok is made to order, with virtually endless possibility for personalisation.



## WANT A UNIQUE VISUAL IDENTITY? JUST ASK.

Our design experts, with decades of experience in operational real estate, will analyse your brand and develop an adhoc colour palette and features for your brand to stand out.

LET'S HAVE A CHAT.

# TESTED & VALIDATED

A full-scale prototype was developed to test informed refinements to proportions, fixing methods, and technical details. Students were then invited to give feedback in a dedicated focus group. The current design is a second-generation of Nestblok, incorporating those lessons-learned.

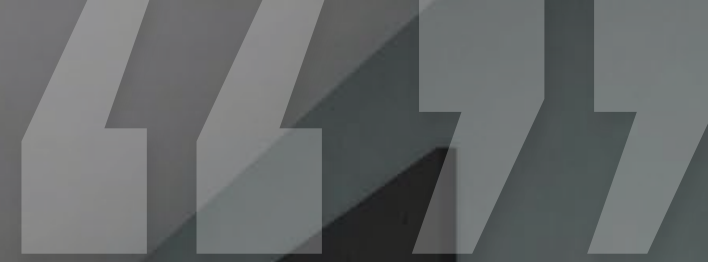

“I like the full-length rails because a wardrobe takes up too much space”

“So Peaceful!”

“I like the cork-board because previously I just stuck things on the wall and the paint peeled off.”

“I really like the idea of having a second stool and moveable desk so someone can sit either side of it, one thing that I find rubbish about student accommodation is that you can't study with somebody also unless you go somewhere like a kitchen.”





# DESIGNER & SUPPLIER

Nestblok was born from a thoughtful collaboration between interior design company A Designer at Heart and furniture supplier LOFT. With market insights and student feedback provided by marketing agency The Property Marketing Strategists.

Building on decades of experience in operational real estate sector, Nestblok was born from a shared ambition to rethink the student bedroom — making it more flexible, personal, and future-ready

On 4 December 2025, Nestblok was awarded Best Interior Design at Property Week Student Accommodation Awards.

“For its fresh flexible approach to student bedroom design shaped by consultation and focused on comfort, personalisation, functionality with the concept standing out for its innovation, adaptability, and strong wellbeing potential”.

**ENQUIRE NOW**



**MARTINA PARDO**

Founder & Director  
A DESIGNER AT HEART  
martina@adesigneratheart.com



**BENJAMIN HALL**

Founder  
benjamin.hall@loft.co.uk



**ALEXANDRA COLLINS**

Senior Sales Executive  
LOFT  
Alexandra.Collins@loft.co.uk



**LAURA CLARKE**

Residential Living Sales, Director  
LOFT  
laura.clarke@loft.co.uk

# NESTBLOK

[WWW.NESTBLOK.COM](http://WWW.NESTBLOK.COM)



email: [info@adesigneratheart.com](mailto:info@adesigneratheart.com)  
mobile: +44 (0)7748821775  
website: [adesigneratheart.com](http://adesigneratheart.com)  
offices: 17 City N Pl, Finsbury Park  
London N4 3FU

# LOFT<sup>®</sup>

email: [hello@loft.co.uk](mailto:hello@loft.co.uk)  
mobile: +44 (0)7543182949  
website: [loft.co.uk](http://loft.co.uk)  
offices: 227 Ayres Road, Old Trafford  
Manchester M16 0NL